

FLAT ROOF AERO EW MOUNTING SYSTEM - GLUED



Non-invasive AERO EW system - glued / welded

Technical specification

System material	aluminium, Magnelis and stainless steel
Roof type	flat roof
The angle of inclination	10°, 15°
Module orientation	horizontal
Assembly system	on the short side up to 70 mm from the edge (on AERO 1 profile)
Roof area for 1 kW	7,01 m ² (for 1650x992 module)
Roof load with modules and ballast	ok. 15 kg/m ² (load may vary depending on building location)

Energy5 recommends using an additional layer of roof membrane under the trapezoidal mounting rails.

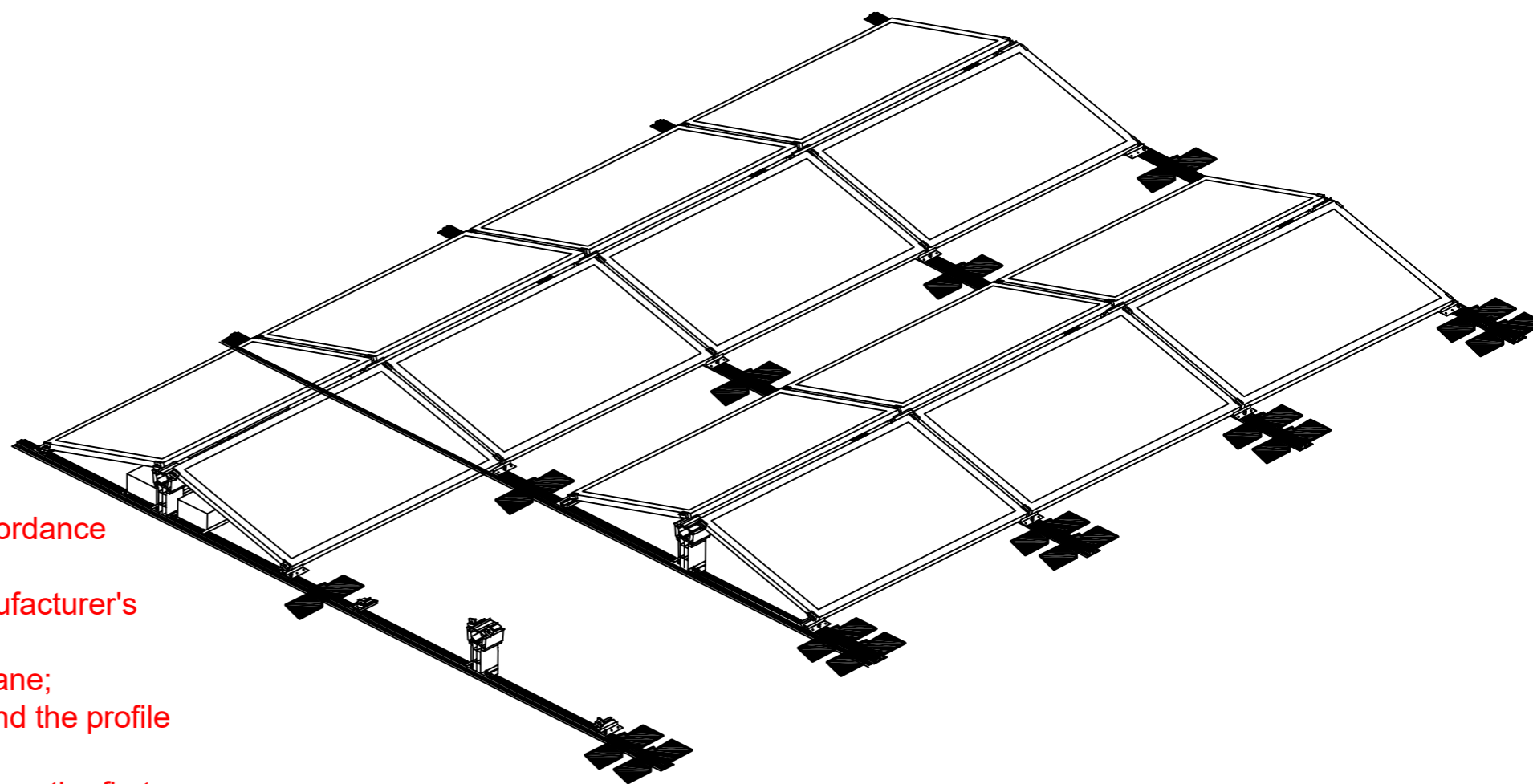

Uwaga:

- The welding connection of the membrane must be made in accordance with the Declaration of Performance;
- Geotextile - if necessary, glue according to the membrane manufacturer's installation instructions;
- The welded stripes must be compatible with the roofing membrane;
- The welded stripes must be located directly in front of and behind the profile as seen from the side;
- If the overlap with mechanical connectors is more than 50 cm from the first row of photovoltaic panels, additional mechanical fastening should be performed, e.g. using telescopic connectors, and then secured with a membrane.
- Before welding the membrane, a test weld should be performed,
- Stripes measuring 9x35 cm

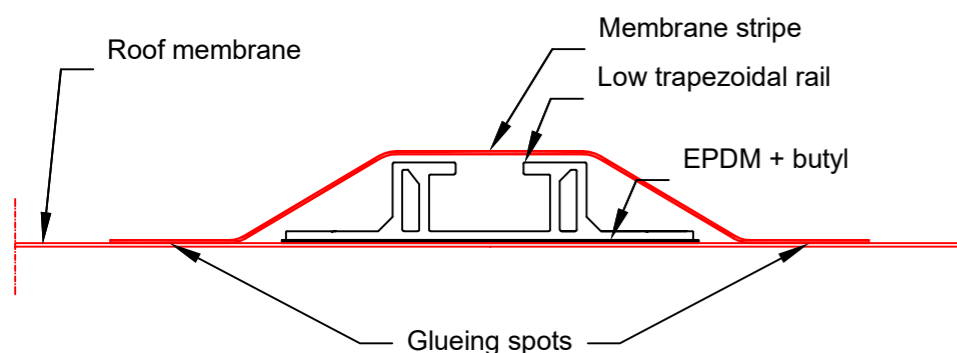

CROSS-SECTION A-A

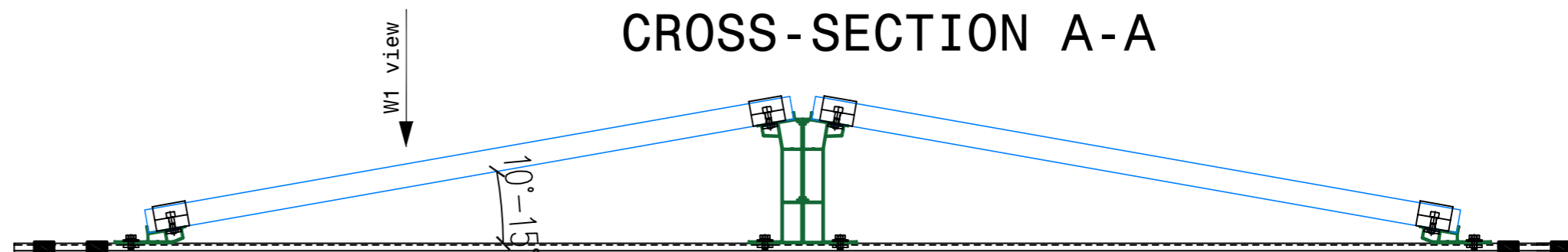

The content of the product card is for informational purposes only and does not constitute an offer within the meaning of the law. Any copying and duplication is prohibited. Energy5 Sp. z o.o. reserves the right to use a different equivalent material than the Magnelis coating. Equivalent means that Energy5 sp. z o.o. has its own tests of the replacement/equivalent material in terms of corrosion conducted by an accredited laboratory. The results of these tests confirm that the parameters are no worse than those of the Magnelis coating.